



TSB SHOWPLACE

Theatre Royal

Technical Specs

NEW PLYMOUTH event venues
CONFERENCES | EXPOS | FUNCTIONS | EVENTS

npeventvenues.nz
npeventvenues@npdc.govt.nz
06 759 6060



THEATRE ROYAL SPECIFICATIONS

Venue Description Rectangular black box theatre built in 1998 on basement level with a combination of flat floor and tiered retractable seating installed in 2010.

Theatre Capacity

Seating	527
Cabaret	336 theatre with 120 at tables
Banquet	350 at tables
Flat Floor	550

Auditorium (337m²):

Wide	16.90m
Length	19.95m
Height	5.00m

Stage Information:

Stage 25mm plywood painted black

Stage rake Flat

Stage opening 14.2m Pros Height 4.07m

Grid elevation 4.65m

Stage depth 8.80m

Stage width 15.85m

1.6m - OP wing

1.6m - P wing

Stage height Auditorium floor to stage height - 0.5m

Grid rating:

Number of loads	Wt / point load
1	500kg at intersection
1	225kg centre of span
2	170kg at third point
3	110kg at quarter points

Curtain

information: Main Curtain

Plum velvet central opening tab track operated from OP

Tabs

1x set black velour tabs at 4.8m

1x set black velour tabs at 8.8m (backdrop)

Legs and borders 5x sets black 525gm velour legs
4.330m long x 2.775m wide

5x black wool serge 565gm boarders
15.2wide .580m drop

Cyclorama

White filled gauze 8.7m installed upon request

Power:

1x PDL CAT 56 5pin 40amp USP floor P

6x PDL CAT 56 5pin 40amp sockets Mezzanine floor OP

NB: 2x PDL CAT 56 5pin 40amp sockets are in use LX dimmer packs

Comms:

Headsets can be hired in upon request.
Can be installed in all relevant areas.

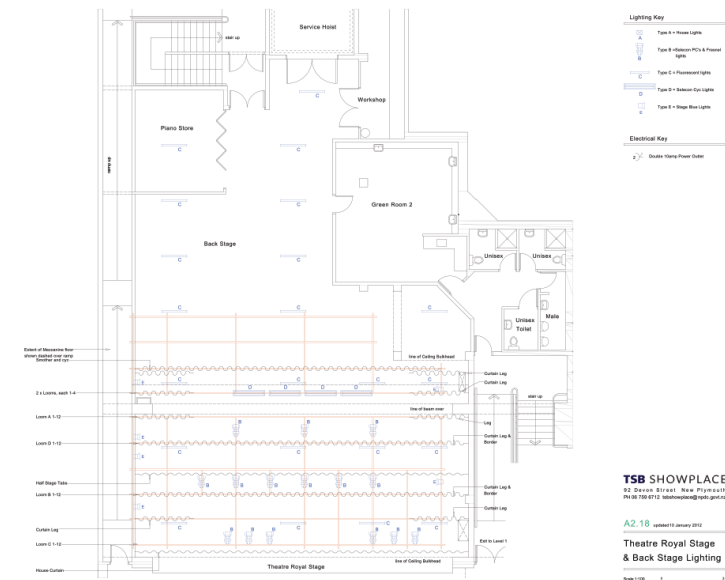

Lighting Equipment: 1x Strand Classic Palette II with 150 Channels, 32 submasters
 2x Theatrelight 12way 2kw dimmer packs
 15x Selecon Fresnels - 1200w
 6x Selecon PC's with barn doors - 1200w
 4x 4-way Selecon cyc units
 6x Truss looms in various locations back to dimmers (4x on stage, 2x Front of House)

Hire Lighting: Follow spot: 1x Selecon Performer - 1200w MSR
NB: depending on availability

House Lights: Slider control available at all control positions

Sound: No sound installed in the Theatre Royal

Sound Levels: Not to exceed 100db at control position

Control Positions: Theatre Style - middle back FOH
 Opposite Prompt- OP
 Prompt - P
 FOH back of auditorium
 Mid auditorium flat floor - centre back floor level
 Control position to OP 35m (tunnel available)



Loading Dock

Door width	2.45m
Door height	5.70m
Width of Dock	2.70m
Height	.85m

Load in stage access Via goods lift
Goods Lift

Lift dimensions	3.6m x 2.6m x 2.6m high
Door width	2.29m
Maximum load	5000kg



Green room

- Back stage
- Kitchen area
- Ever boiler zip
- Microwave
- Fridge / Freezer
- 1x tables and various chairs
- TV with live stage picture
- First aid kit

Dressing Rooms: Dressing room located in the Green Room (cap 15)
2 mirrored walls with mirror lights above the mirrors
2x wall continuous bench under mirrors
5x curtain cubical
3x basins (hot water)
2x shower areas/toilets.
1x disabled toilet
Men's urinals
Other options available if required.



Internet High speed WIFI access for Hirer and Standard free public WIFI.

Parking One car park is allocated per venue. If additional parking is required please contact Operations Supervisor. Unauthorised vehicles will be towed away or clamped at the owner cost.

Additional staff Additional staff can be arranged at an extra cost. Please refer to Schedule A in the venue hire contract for rates.

Additional lighting and sound hire can be arranged through the operations team.

Further information Enquiries should be addressed to:
Operations Supervisor
TSB Showplace
Private Bag 2025
New Plymouth 4342

DDI: +64 (0) 6 759 2552

CEL: +64 (0)27 432 6860

david.liggett@npdc.govt.nz

NEW PLYMOUTH event venues

CONFERENCES | EXPOS | FUNCTIONS | EVENTS

TSB SHOWPLACE



TSB *Stadium*



npeventvenues.nz
npeventvenues@npdc.govt.nz
06 759 6060

