

TSB SHOWPLACE

TSB Theatre

Technical Specs

NEW PLYMOUTH event venues
CONFERENCES | EXPOS | FUNCTIONS | EVENTS

npeventvenues.nz
npeventvenues@npdc.govt.nz
06 759 6060



TSB THEATRE SPECIFICATIONS

Theatre Capacity	Stalls	450
	Circle	222
	Gallery	283
	Total	955
	Boxes	FOH LX and PA block viewing of the stage

Stage information 25mm Plywood painted black

Stage rake 50mm over the 12.6m stage depth

Pro-Arch Stage Opening Width 8.93m / Height 7.2m

Stage depth

Pro-Arch to back wall	10.9m
Apron	1.7m
Total depth:	12.6m

NB: Pro-Arch to Line 45 (Cyc) 9.3m

Stage width

Inside Pro-arch	8.93m
P side Wing	4.38m
OP Wing	4.24m stepped to 8.4m

Elevations from stage

Grid Height	17.8m
Drift	16.15m
Fly Floor	7.4m

Orchestra pit

Width	10.8m
Depth	2.05m, extendable to 2.9m (additional cost)
Height	600mm
Pit floor to stage	1.8m

Loading dock

Door width	2450mm
Door height	5700mm
Width of Dock	2700mm
Height	850mm

Stairs to stage Removable: 2x sets: 1m width, 6 steps, stage level to stalls over Orchestra Pit 1.2m

Fire curtain Set within the Pro arch
NB: Tested prior to each public performance

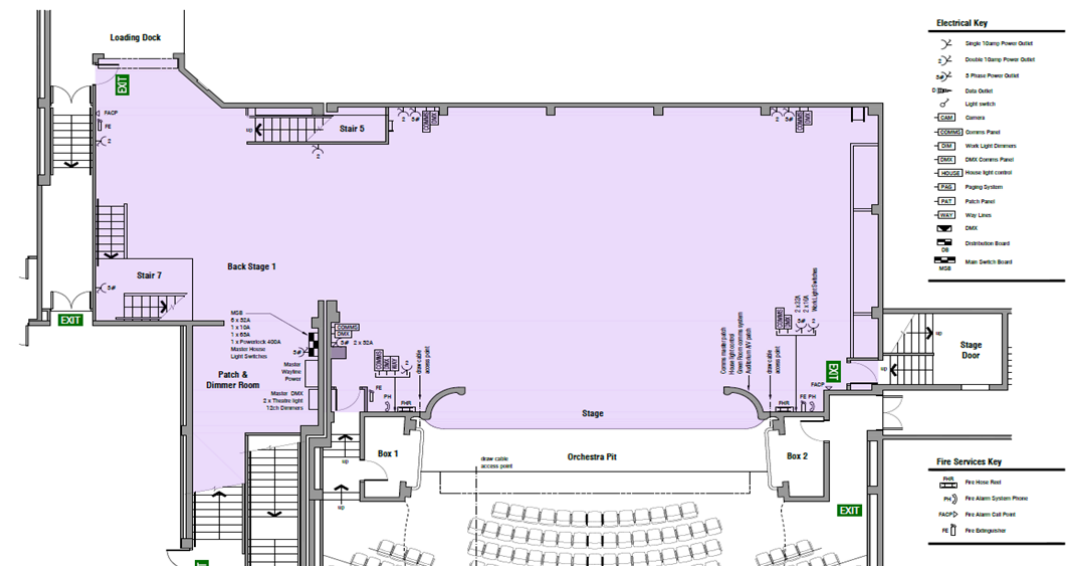

Flying

Third Stage Counter weight system - 45 Lines

- Line 1 in use with the house curtain
- Lines 1 – 6 - operated from the fly floor
- Lines 7 – 45 - operated from Stage level or breaks can be moved to the fly floor as required

Batten length	12m
Batten width	50mm
Batten height	75mm
Maximum Batten Load	450kg distributed
Maximum point load	250kg

Lineset

1	0.000 (house curtain)	24	5.065
2	0.210	25	5.275
3	0.425	26	5.465 (# 3 border)
4	0.640 (LX 01)	27	5.665 (# 3 legs)
5	0.850	28	5.865
6	1.065	29	6.085 (LX 03)
7	1.270	30	6.260
8	1.485 (# 1 border)	31	6.460
9	1.695 (# 1 Legs)	32	6.660
10	1.910		Principal
11	2.120	33	7.195
12	2.335	34	7.380
13	2.550	35	7.560
	Principal	36	7.755 (# 4 border)
14	3.070 (# 2 border)	37	7.930 (# 4 legs)
15	3.265 (# 2 legs)	38	8.110
16	3.470	39	8.295 (LX 04)(cyc lights)
17	3.670	40	8.480
18	3.870 (LX 02)	41	8.650
19	4.065	42	8.845
20	4.270	43	9.030
21	4.475 (Mid Stage Tab Curtain)	44	9.210
22	4.670	45	9.395 (cyc)
23	4.870		

Rigging – stage

5x I beams running down stage 1 tonne load

Gallery lighting rail 30kg per metre or 70kg point load 3m apart

Rigging - FOH

3x rigging points above proscenium arch,

5m down stage of the fire curtain: rated at 250kg SWL each

3x access holes 400mm down stage of the fire curtain to access L beams at grid

1x Centre Proscenium rigging point rated at 250kg SWL

Main Curtain

375g Red velvet central opening tab track or flown

Tabs

Black heavy weight wool serge

Smother

Black heavy weight wool serge

Legs and Borders

4x sets black heavy weight velvet leg width 3m – drop 8.6m

4x sets black heavy weight wool serge borders width 12m – drop 3.2m

Cyclorama

PVC – Colour: Milky white - width 13m – drop 8m



Power	1x 400amp 3phase show connection (off stage OP side) 1x set power lock connectors (off stage OP side) 1x 63amp (off stage OP side) 21x PDL Cat 56 40amp sockets DMX 512 connections beside all except follow spot box			
Power locations	Stage	2x DSP 1x DSOP 1x USP 1x USOP	Fly floor	1x DSP 1x USP 2x DSOP 2x CSOP
	Dimmer bay	6x for House Dimmers		
	Front of house	1x OP Box 1x P Box 2x Ceiling above Pro arch		
	Follow spot box	1x 40amp 3phase or 32 amp 3phase		
Lighting equipment	8x 1000w Selecon profiles 36x 1200w Selecon high performance fresnels Standard Rig – four colour wash • Red – L106 • Blue – L119 • Amber – L105 • Green – L124 4x 4-way Selecon Aurora Cyc Lamps 17x Pacific's 12/28 1x Strand Pallet VL 64 Lighting Desk with 20" wide screen monitor 4x Theatrelight 12 way 2kw dimmers on fly floor 2x Theatrelight 12way 2kw dimmers on stage 40x FOH circuits (on gallery rail, circle boxes & booms) NB: Gallery rail (right around 'P' Box to 'OP' Box) 4x Spot Bars (20 flex looms on each) 6x Ladders (lines from fly floor bridge) 2x Circle Box Booms DMX 512 & House light control (various locations) NB: Rear OP stalls, Control position P Stage, OP Circle lighting control			

Lighting equipment contd.

LED stage work lights are mounted on each LX Bar – not DMX controlled

Hire Lighting

Follow spot: 1x Selecon Performer 1200w MSR
Follow spot: 1x Selecon Rua 9-16°
NB: depending on availability

Coms

Corded Belt packs and headsets can be hired in upon request (can be installed in all relevant areas)

Sound

No sound installed in the TSB Theatre

Sound levels

Not to exceed 100db at control position.

Control position

Positioned OP side of centre section stall level
Width 4.6m
Depth 1.8m

Cable run tunnel from the control position is under the seating running to the orchestra pit and to the stage via the holes on each side of the pro arch – Due to the fire curtain no cables are able to run through the pro arch opening.

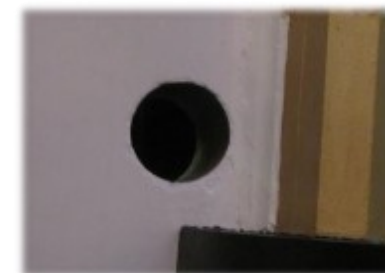

Green room	<p>Under stage, stair access from OP and P</p> <p>2x two-seater black leather couches</p> <p>2x black leather tub chairs</p> <p>Large vintage table with 8 chairs</p> <p>TV – Freeview and stage</p> <p>2x full length mirrors</p> <p>Kitchen area:</p> <ul style="list-style-type: none"> - central island with draws and power - 3x bar stools - side bench with 4x bar stools, 3x USB charging points - Ever boiler zip - Microwave - double-draw dishwasher - 2x 380 ltr fridges 	Showers	2x private cubical off the green room
		Laundry	<p>1x 8kg washing machine (Dream queen)</p> <p>Wash times are 45 minutes no short wash</p> <p>1x 4.5kg dryer</p> <p>1x laundry tub</p> <p>1x iron board</p> <p>1x steam iron</p>
		Internet	High-speed WIFI access for Hirer and standard free public WIFI
		Parking	One carpark is allocated for per venue. If additional parking is required please contact Operations Supervisor. Unauthorised vehicles will be towed at owner's cost.
First Aid kit	On top of fridge in Green room	Additional staff	<p>Additional staff can be arranged at an extra cost:</p> <p>Please refer to Schedule A in the venue hire contract for rates.</p>
Dressing Rooms	<p>Off Green Room (cap 30+)</p> <p>1– 8 each fitted out with:</p> <p>1x TV picturing live stage image and sound</p> <p>1x basin (hot water)</p> <p>3x mirrors with side makeup lights</p> <p>4x chairs</p> <p>Ceiling-hung clothes rail 1.m long</p> <p>9 -10 lower level dressing rooms (cap 50 +) each fitted with:</p> <p>1x TV picturing live stage image and sound</p> <p>2x basins (hot water)</p> <p>5x mirrors with side makeup lights</p> <p>Chairs</p> <p>Ceiling Hung clothes rail 2m long</p>	Additional lighting and sound hire can be arranged through the operations team.	
		Further information	<p>Enquiries should be addressed to:</p> <p>Operations Supervisor</p> <p>TSB Showplace</p> <p>Private Bag 2025</p> <p>New Plymouth 4342</p> <p>DDI: +64 (0) 6 759 2552</p> <p>CEL: +64 (0)27 432 6860</p> <p>david.liggett@npdc.govt.nz</p>
In addition:	<p>Room 1 - wall heater</p> <p>Room 7 – lockable</p> <p>Rooms 5 & 8 – have additional mirrors</p>		

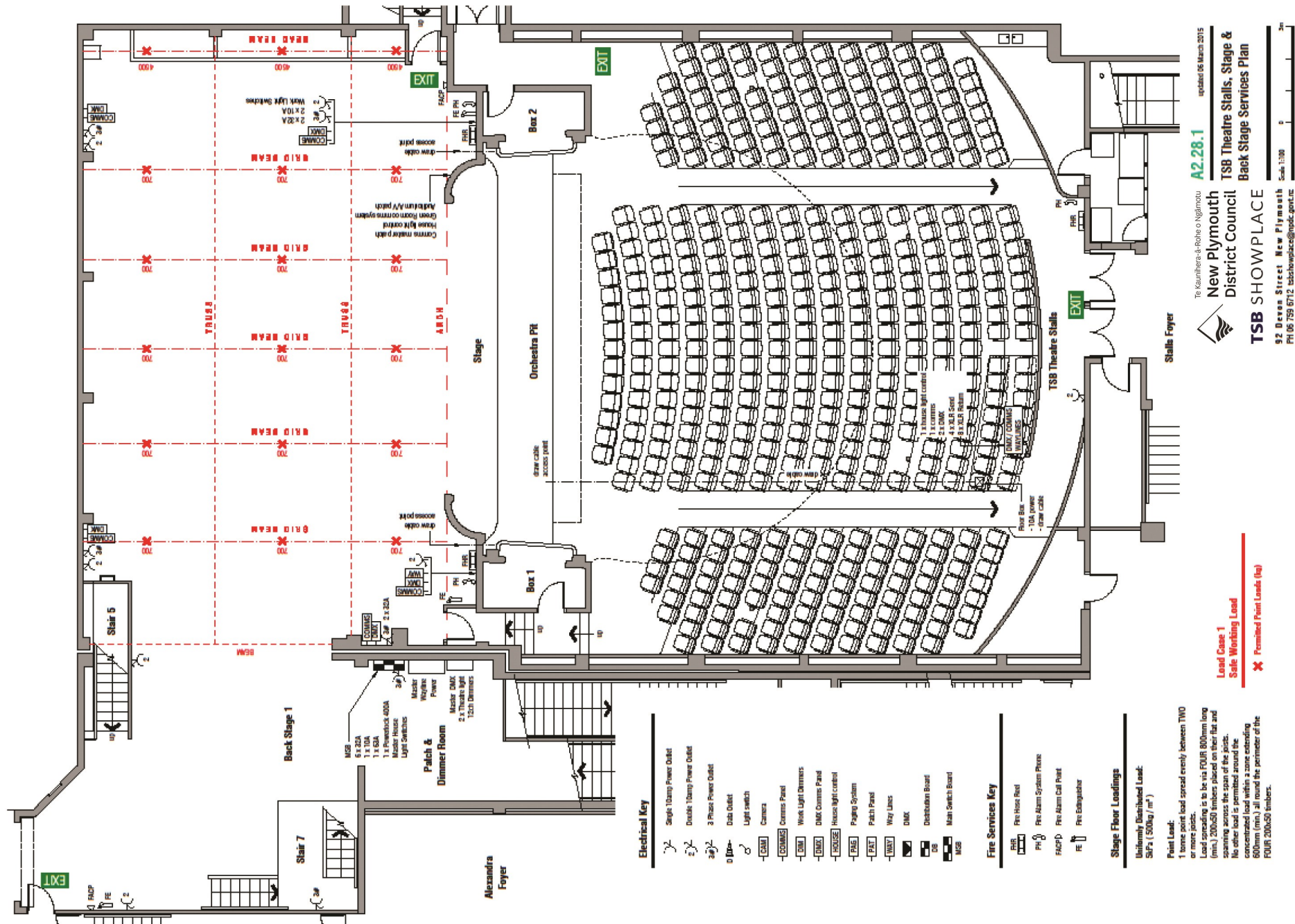

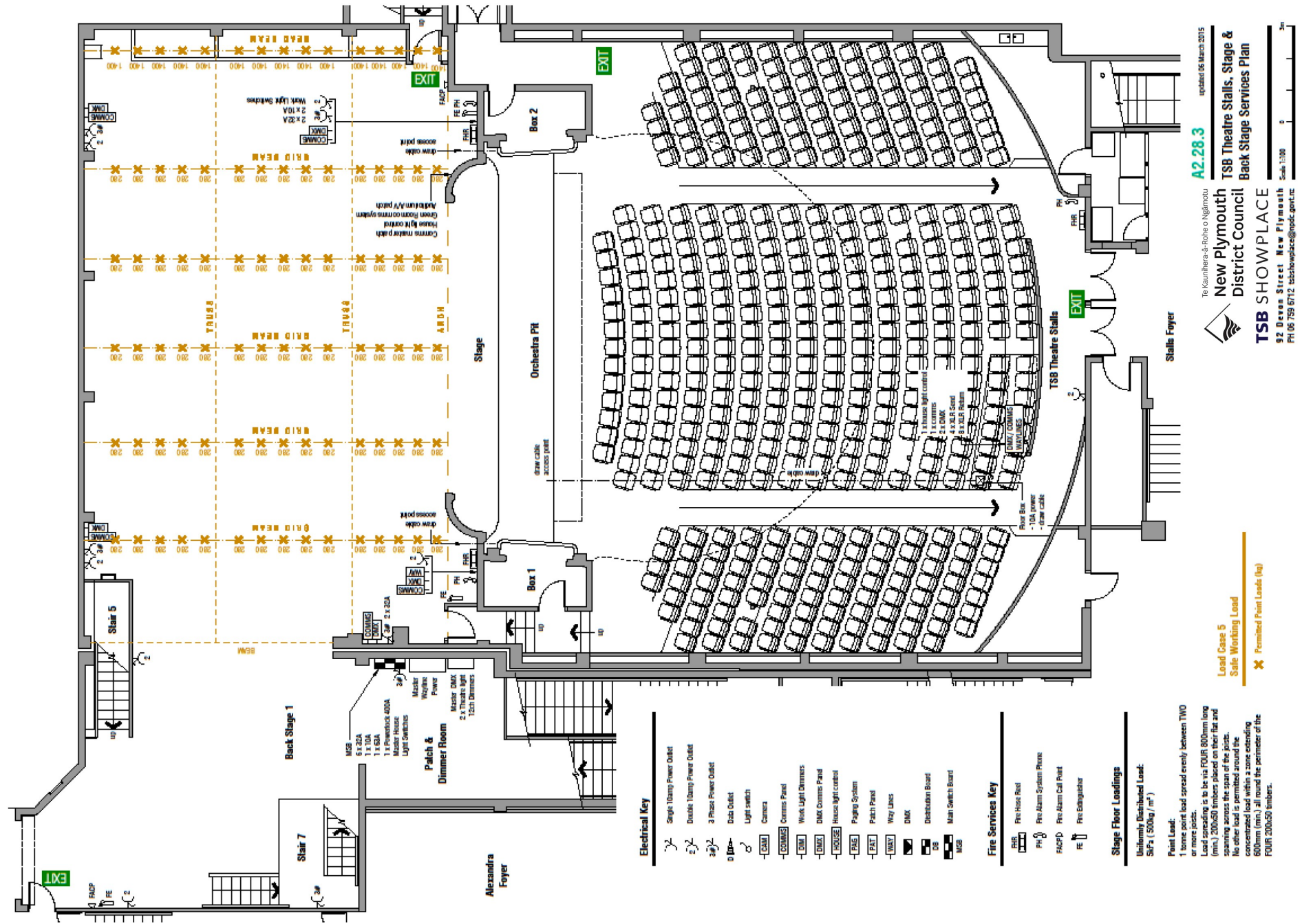

NEW PLYMOUTH event venues

CONFERENCES | EXPOS | FUNCTIONS | EVENTS

TSB SHOWPLACE



TSB *Stadium*



npeventvenues.nz
npeventvenues@npdc.govt.nz
06 759 6060

